

CHAPEAU BOULONNE / BOLTED BONNET  
SIEGE VISSE / RENEWABLE SEAT

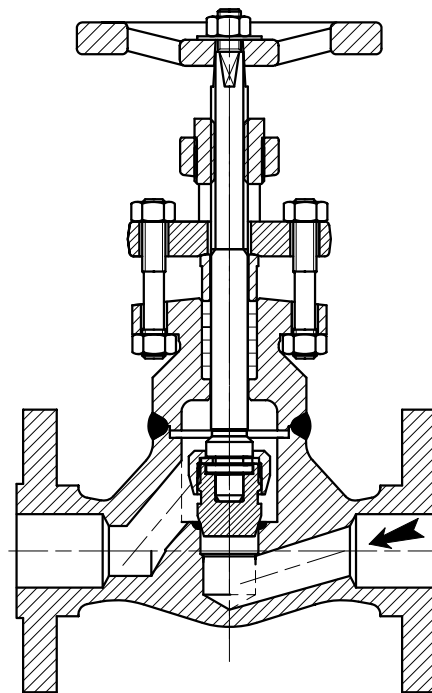

CHAPEAU SOUDE / WELDED BONNET  
SIEGE INTEGRAL / INTEGRAL SEAT

*Encombrement A suivant NFE 29-305*  
*Face to face acc. ANSI B16.10*  
Matériel conforme à NF M87.412- BS5352  
*Matériel in acc. with BS 5352 - NF M87.412*

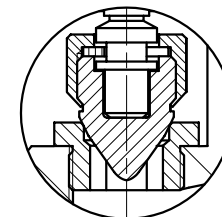

Clapet pointeau en option  
*Needle disc option*

Rep.	DESIGNATION
1	CORPS/BODY
2	SIEGE/SEAT
3	CLAPET/DISC
4	TIGE/STEM
5	ECROU DE CLAPET/DISC NUT
6	VERROU DE CLAPET/LOCKNUT WASHER
7	JOINT DE CHAPEAU/BONNET GASKET
8	CHAPEAU/BONNET
9	GARNITURE D'ETANCHEITE/PACKING
10	FOULOIR/GLAND
11	BRIDE DE FOULOIR/GLAND FLANGE
14	TIRANT/GLAND FLANGE STUD
15	ECROU DE TIRANT/GLAND FLANGE NUT
16	DOUILLE/BUSHING
17	VOLANT/HANDWHEEL
18	ECROU DE VOLANT/HANDWHEEL NUT
19	PLAQUE D'IDENTIFICATION/NAME PLATE
20	VIS DE CHAPEAU/BONNET SCREW



CS 3422  
112,114 avenue de Vendôme  
41034 BLOIS Cedex  
FRANCE

**ROBINET FORGE A SOUPAPE A BRIDES**  
**FLANGED FORGED GLOBE VALVE**  
Sie / Class 150 - 300 - 600 - 900 - 1500 - 2500  
*PN 10 - 16 - 25 - 40 - 65 - 100 - 160*

CHAPEAU BOULONNE - CHAPEAU SOUDE / SIEGE VISSE - SIEGE INTEGRAL  
*BOLTED BONNET - WELDED BONNET / RENEWABLE SEAT - INTEGRAL SEAT*